

FRESH START is intended for use in hospitals and healthcare settings, laundry rooms, laboratory, transport vehicles, veterinary clinics, zoos, beauty salons, barber shops, funeral homes, mortuaries schools, gyms, shopping centers, and catering facilities.

DIRECTIONS FOR USE: It is a violation of Federal Law to use this product in a manner inconsistent with its labeling. This product is not for use on critical and semi-critical medical device surfaces.

CLEANING: Use one Fresh Start wipe to completely remove all gross debris from surfaces to be treated.

DISINFECTING: To disinfect hard, non-porous surfaces, thoroughly wet the surface to be treated. Treated surface must remain visibly wet for disinfecting. Use enough wipes for treated surface to remain visibly wet for 5 minutes. For heavily soiled surfaces, clean before following disinfecting instructions. Allow surfaces to air dry.

FRESH START is an effective disinfectant against Escherichia coli (E. coli) 0157:H7 (ATCC 43895), Salmonella enterica (ATCC 10708), Pseudomonas aeruginosa (ATCC 15442), Staphylococcus aureus (ATCC 6538), Streptococcus pyogenes (Strep) (ATCC 19615), Community Associated Methicillin resistant Staphylococcus aureus Genotype USA400 and Community Associated Methicillin resistant Staphylococcus aureus Genotype USA300, Methicillin resistant Staphylococcus aureus (MRSA), Vancomycin Resistant Enterococcus faecium (VRE) and Vancomycin intermediate resistant Staphylococcus aureus (VISA).

***VIRUCIDAL / BACTERICIDAL / PSEUDOMONICIDAL**

FRESH START®

ANTIBACTERIAL FORMULA CLEANS AND DISINFECTS IN ONE STEP

KILLS HIV-1, KILLS FLU VIRUS††
KILLS ANTIBIOTIC RESISTANT BACTERIA: CA-MRSA, MRSA, VISA, VRE AND NDM-1
KILLS PANDEMIC 2009 H1N1 INFLUENZA A VIRUS
FAST AND EFFECTIVE CLEANING
KILLS 99.9% OF BACTERIA IN 15 SECONDS**
ALCOHOL, SOLVENT, BLEACH FREE

ACTIVE INGREDIENTS:

Alkyl (60% C ₁₄ , 30% C ₁₆ , 5% C ₁₂ , 5% C ₁₈) dimethyl benzyl ammonium chlorides	0.14%
Alkyl (68% C ₁₂ , 32% C ₁₄) dimethyl ethylbenzyl ammonium chlorides	0.14%
INERT INGREDIENTS	99.72%
TOTAL	100.00%

CAUTION

KEEP OUT OF REACH OF CHILDREN

See side panels for additional precautionary statements.

††Influenza A₂ / Japan

** Staphylococcus aureus (Staph), Klebsiella pneumoniae, Listeria monocytogenes, Escherichia coli (E. coli), 0157:H7

NET CONTENT: MINIMUM WEIGHT 2 lbs. 1 oz.
160 WIPES PER ROLL, 7" X 7" (18cm x 18cm)

***VIRUCIDAL ACTIVITY:** Fresh Start is an effective virucide on hard, non-porous surfaces against Influenza A2/Japan, Herpes Simplex Virus1 (ATCC VR-260), Human Immunodeficiency Virus, Type 1 (HIV-1) and Herpes Simplex Virus 2 (ATCC VR-734) when the treated surface is allowed to remain wet for 5 minutes. Allow surface to air dry.

KILLS HIV-1 ON PRE-CLEANED ENVIRONMENTAL SURFACES/ OBJECTS PREVIOUSLY SOILED WITH BLOOD/BODY FLUIDS in health care settings (hospitals, nursing homes) or other settings in which there is an expected likelihood of soiling of inanimate surfaces/objects with blood or body fluids, and in which the surfaces/objects likely to be soiled with blood or body fluids can be associated with the potential for transmission of Human Immunodeficiency Virus Type 1 (HIV-1).

SPECIAL INSTRUCTIONS FOR CLEANING AND DECONTAMINATION AGAINST HIV-1 OF SURFACES/ OBJECTS SOILED WITH BLOOD/BODY FLUIDS.

PERSONAL PROTECTION: When handling items soiled with blood or body fluids, use disposable latex gloves, gowns, masks and eye coverings.

CONTACT TIME: Allow surface to remain wet for 5 minutes.

DISPOSAL OF INFECTIOUS MATERIALS: Blood and other body fluids should be autoclaved and disposed of according to local regulations for infectious waste disposal.

FUNGICIDAL ACTIVITY: Fresh Start is an effective fungicide against Trichophyton mentagrophytes (ATCC 9533) causative agent of Athlete's Foot Fungus, when used as directed on hard surfaces found in bathrooms, shower stalls, locker rooms,

exercise facilities or other clean, hard, non-porous, surfaces commonly contacted by bare feet. The surface must remain visibly wet for 3 minutes. Allow surfaces to air dry.

EFFICACY TESTS HAVE DEMONSTRATED THAT FRESH START IS AN EFFECTIVE BACTERICIDE, VIRUCIDE AND FUNGICIDE IN THE PRESENCE OF ORGANIC SOIL (5% BLOOD SERUM)

SANITIZING/DEODORIZING: TO SANITIZE / DEODORIZE HARD, NON-POROUS SURFACES; wipe surface, using enough wipes to allow treated surface to remain wet for 15 seconds for Staphylococcus aureus (Staph), Klebsiella pneumoniae, Listeria monocytogenes, Escherichia coli (E. coli) 0157:H7 for 60 seconds for Campylobacter jejuni. Let surface dry.

For highly soiled surfaces, clean excess dirt first.

For surfaces that may come in contact with food, a potable water rinse is required.

For plastic and painted surfaces, spot test on an inconspicuous area before use.

Fresh Start will not harm surfaces: including acrylic, fiberglass and vinyl.

DO NOT USE ON UNPAINTED WOOD. NOT FOR PERSONAL CLEANSING. THIS IS NOT A BABY WIPE! DO NOT FLUSH IN TOILET.

MANUFACTURED FOR:

Aberrant Ventures
6050 Peachtree Pkwy / Suite 240 – 219
Norcross GA 30092

678-250-4146

EPA REG No.: 1839-190-63584

EPA EST No.: 97360-CA-001

EPA EST No.: 97360-CA-002

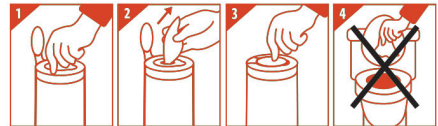

TO OPEN PACKAGE: Remove lid from canister. Lift flap in center of lid. Pull up corner of center wipe, twist to a point and thread through dispenser hole in lid. **DO NOT PUSH FINGER THROUGH OPENING.** Replace lid. Pull out exposed wipe and snap off. The next wipe pops up automatically. Dispose of used wipes in trash receptacle. Snap center flap down when finished to retain moisture. **DO NOT FLUSH.**

PRECAUTIONARY STATEMENTS
HAZARDS TO HUMANS AND DOMESTIC ANIMALS

CAUTION: Causes moderate eye irritation. Avoid contact with eyes or clothing. Wash thoroughly with soap and water after handling.

FIRST AID: Have the product canister or label with you when calling a poison control center or doctor, or going for treatment.

IF IN EYES: Hold eyes open and rinse slowly and gently with water for 15-20 minutes. Remove contact lenses if present, after the first 5 minutes, then continue rinsing. Call a poison control center or doctor for treatment advice.

STORAGE AND DISPOSAL

DO NOT CONTAMINATE WATER, FOOD OR FEED BY STORAGE OR DISPOSAL.

CANISTER STORAGE/DISPOSAL: Store in an area inaccessible to children. Wipes: Dispose of wipe in trash after use. Do not flush. Canister: Tightly close lid between uses to retain moisture. Nonrefillable container. Do not reuse or refill this canister. Offer empty canister for recycling if available or discard in trash.

