

LINE	DIRECTION	DISTANCE
L1	S18° 03'05"W	199.10
L2	N80° 33'46"W	240.59
L3	N18° 05'20"E	316.30
L4	S79° 33'45"E	186.21
L5	S10° 36'54"W	188.17
L6	N81° 31'36"W	208.66
L7	N17° 07'41"E	196.66

CURVE	LENGTH	DELTA	RADIUS	DIRECTION	CHORD
C1	752.34	31° 15'42"	1378.87	S84° 20'22"W	743.04

THIS SURVEY WAS PREPARED WITHOUT THE BENEFIT OF SCHEDULE "B" OF A CURRENT TITLE COMMITMENT, THEREFORE ALL EASEMENTS OF RECORD MAY NOT BE SHOWN HEREON.

SUBJECT OF ANY RULES, REGULATIONS, ORDINANCES, ETC., AS SET FORTH BY THE COUNTY OF BLANCO.

I, RANDALL H. HAMBRIGHT, A REGISTERED PROFESSIONAL LAND SURVEYOR IN THE STATE OF TEXAS, DO HEREBY CERTIFY THAT A SURVEY UPON THE GROUND OF THE PROPERTY SHOWN HEREON HAS BEEN PERFORMED BY ME AND THAT IS TRUE AND ACCURATE AND THAT THERE ARE NO DISCREPANCIES, CONFLICTS, ENCROACHMENTS OR VISIBLE UTILITY LINES KNOWN TO ME EXCEPT AS SHOWN HEREON AND THAT SAID PROPERTY HAS ACCESS TO AND FROM A PUBLIC ROADWAY.

06-10-22

DATE

Randall H. Hambright

RANDALL H. HAMBRIGHT, R.P.L.S.
TEXAS CERTIFICATE NO. 5263, TEXAS
COUNTY SURVEYOR, BLANCO COUNTY

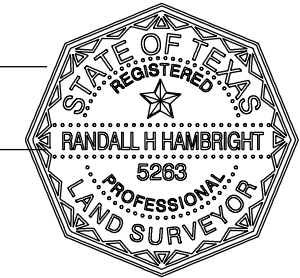

LEGEND

- 1/2" IRON ROD FOUND
- FENCE POST FOUND AS NOTED
- △ CALCULATED POINT
- () RECORD INFORMATION
- IRON FENCE
- x- WIRE FENCE
- OU OVERHEAD UTILITIES
- ⊕ WATER WELL
- ⊙ WINDMILL
- ⊙ SEPTIC

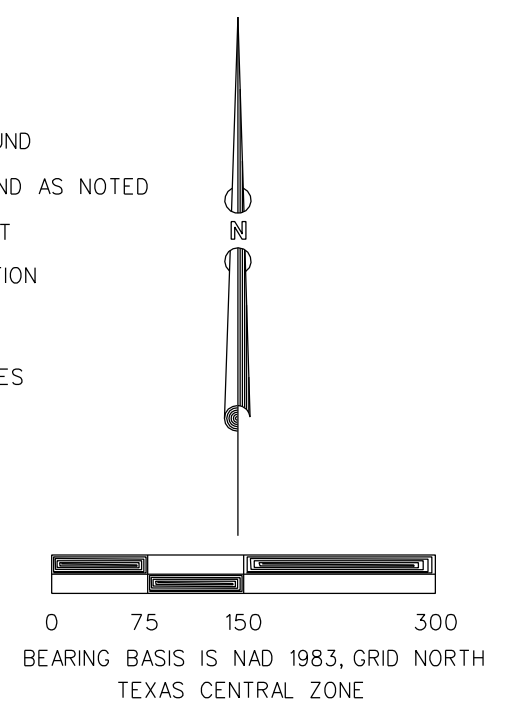

MAP TO ACCOMPANY FIELD NOTE NO. 022-132

SURVEY OF A 31.70 ACRE TRACT SITUATED IN THE B. WILLIAMS SURVEY NO. 25, ABSTRACT NO. 4, BLANCO COUNTY, TEXAS

HAMBRIGHT LAND SURVEYING

P.O. BOX 1226
JOHNSON CITY, TEXAS 78636
PHONE (830) 868-2574
EMAIL: HAMBRIGHTSURVEY@GMAIL.COM
TEXAS FIRM NO. 100587-00

DATE: 06-10-22
JOB NO. 022-132