



ENLITE[®]

DELUXE OTC
HEARING AIDS



**MANUAL
ENGLISH**

Welcome

We're thrilled to help you enjoy more of everything you love again.

Please read these instructions first to tap into the full potential of your device.

Thank you for choosing Enlite®

WARNING: If you are younger than 18, do not use this.

You should talk to a doctor, preferably an ear-nose-throat doctor (an ENT), because your condition needs specialized care. Over-the-counter hearing aids are only for users who are age 18 or older.

This OTC hearing aid is for users who are 18 and older. People who are younger than 18 with hearing loss should see a doctor, preferably an ENT, because they may need medical testing and management. Hearing loss can affect speech and learning, so professional fitting and continuing care are also important.

WARNING: When to See a Doctor

If you have any of the problems listed below, please see a doctor, preferably an ear-nose-throat doctor (an ENT).

- Your ear has a birth defect or an unusual shape.
Your ear was injured or deformed in an accident.
- You saw blood, puss, or fluid coming out of your ear in the past 6 months.
- Your ear feels painful or uncomfortable.
- You have a lot of ear wax, or you think something could be in your ear.
- You get really dizzy or have a feeling of spinning or swaying (called vertigo).
- Your hearing changed suddenly in the past 6 months.
- Your hearing changes: it gets worse then gets better again.
- You have worse hearing in one ear.
- You hear ringing or buzzing in only one ear.

WARNING: This hearing aid should not cause pain when inserting it.

Remove this device from your ear if it causes pain or discomfort when you insert or place it. To try again, make sure to follow the instructions. If you feel pain or discomfort again, contact the manufacturer. If your pain or discomfort doesn't go away, contact your hearing healthcare professional. You can also report this to FDA as an adverse event according to the instructions that appear later.

Caution: This is not hearing protection.

You should remove this device if you experience overly loud sounds, whether short or long-lasting. If you're in a loud place, you should use the right kind of hearing protection instead of wearing this device. In general, if you would use ear plugs in a loud place, you should remove this device and use ear plugs.

Caution: The sound output should not be uncomfortable or painful.

You should turn down the volume or remove the device if the sound output is uncomfortably loud or painful. If you consistently need to turn the volume down, you may need to further adjust your device.

Caution: You might need medical help if a piece gets stuck in your ear.

If any part of your hearing aid, like the ear tip, gets stuck in your ear, and you can't easily remove it with your fingers, get medical help as soon as you can. You should not try to use tweezers or cotton swabs because they can push the part farther into your ear, injuring your eardrum or ear canal, possibly seriously.

Note: If you remain concerned, consult a professional.

If you try this device and continue to struggle

with or remain concerned about your hearing, you should consult with a hearing healthcare professional.

Note: What you might expect when you start using a hearing aid.

A hearing aid can benefit many people with hearing loss. However, you should know it will not restore normal hearing, and you may still have some difficulty hearing over noise. Further, a hearing aid will not prevent or improve a medical condition that causes hearing loss.

People who start using hearing aids sometimes need a few weeks to get used to them. Similarly, many people find that training or counseling can help them get more out of their devices.

If you have hearing loss in both ears, you might get more out of using hearing aids in both, especially

in situations that make you tired from listening—for example, noisy environments.

Note: Tell FDA about injuries, malfunctions, or other adverse events.

To report a problem involving your hearing aid, you should submit information to FDA as soon as possible after the problem. FDA calls them "adverse events," and they might include: skin irritation in your ear, injury from the device (like cuts or scratches, or burns from an overheated battery), pieces of the device getting stuck in your ear, suddenly worsening hearing loss from using the device, etc.

Instructions for reporting are available at <https://www.fda.gov/Safety/MedWatch>, or call 1-800-FDA-1088. You can also download a form to mail to FDA.

CONTENTS

Intended Use	8
What's Inside	9
Quick Start Guide.....	10-11
Batteries	12-14
Choosing the Correct Ear Tip	14
Replacing the Ear Tips.....	15
Wearing Your Hearing Aids.....	16-17
Importance of Deep Seal	18
Operation	19
Listening Profile Adjustments	20
General Product Care.....	21
Changing Filters	22-23
Troubleshooting.....	24
Technical Data.....	25
Warranty	26-27
Battery Safety	28-29

Intended Use

Enlite® Hearing Aids have high-frequency emphasis for soft sounds, so the faint sounds of speech can be heard more easily – especially if the speaker is farther away than desirable or speaks very softly. The most common example is someone asking a question from another room. Soft speech can also be heard in a house of worship, classroom, courtroom, lecture hall, theatre, or TV dialog. For many users, hearing aid devices are like reading glasses: they are used only part of the time.

Adjusting to hearing aids:

- Most hearing aid users find the ear tips comfortable to wear for many hours right away. Others do not.
- Take your time.
- You may want to wear your hearing aids for short periods until you can wear them for as long as you wish.
- If the ear tips that come on hearing aids are not comfortable or do not seal well in the ear, try other ear tip styles supplied to determine which size is right for you.

- 1 pair Hearing Aids
- 6 pair assorted tips
- Filter tool & additional filters
- Cleaning tool
- Hard case
- #10 batteries
- User manual



#10 Batteries

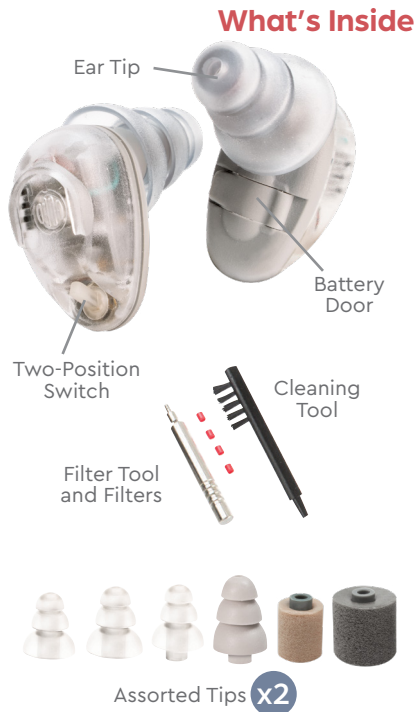

Quick Start Guide

1 BATTERY AND ON/OFF

- Open the battery door — located on the bottom of the device.
- Remove the yellow tab from battery.
- Place the battery in the door and close.
- Turn on by closing the battery door.
- Turn off by opening the battery door.

Note: Door will not close if the battery is inserted incorrectly.

Note: Battery does not need to be removed if the door is open far enough to turn off the device.

2 EAR TIPS AND PROPER INSERTION

The ear tip that is most comfortable and seals the ear is the best choice.

To properly insert:

Pull ear up and out. Using a twisting motion, position the device horizontally in the ear with the switch toward the back of the ear.

NOTE: Ear tips are reusable. Replace 3-flange ear tips every 60–90 days and foam ear tips regularly.

NOTE: Feedback (whistling) may be heard while inserting the device until it is fully sealed in the ear. It is perfectly natural. It will go away when the ear tip is sealed in the ear.

3 OPERATING THE SWITCH

LOW SETTING

Flip the switch toward the front of the device.

HIGH SETTING

Flip the switch toward the back of the device for more sound.

TIP: Some people can flip the switch when the device is in the ear, but it is not unusual that you will have to take it out of your ear to change the switch position.

Refer to page 20 for complete instructions and page 24 for troubleshooting information.

Battery Insertion

The batteries must be inserted correctly or the hearing aids will not work.

1. The battery compartment is located on the underside of the hearing aids.
2. Open the battery door.
3. Remove the yellow tab from the battery.
4. Insert the battery with the flat side facing up.
5. Do not force the battery into the door.

Note: The door will not close if the battery is not inserted correctly.

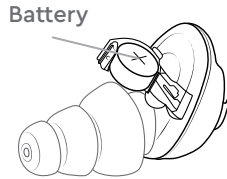
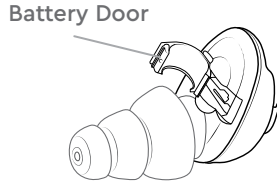

Zinc-Air Batteries

Hearing aids use commonly available #10 zinc-air Hearing aid batteries. They are easy to find in pharmacies, online and other retail locations.

Estimated Battery Life:

9 days continuous operation

2 weeks (approx) if turned off when not in use

- Once the tab is removed, zinc-air batteries may self-discharge in about 4 weeks whether used or not.
- The discharge rate varies with temperature and humidity.
- It is sometimes possible to prolong the life of a battery by replacing the tab over the air holes, but results vary.
- Zinc-air batteries do not have to be recycled.
- Zinc-air batteries can be disposed in the trash.
- Zinc-air batteries are not rechargeable.

Low Battery Warning

A feature called LOBAT™ alerts you when the battery is at the end of its life.

- A slow, quiet ticking sound gradually becomes faster and louder, like the sound of a motorboat.
- After the warning sound first becomes audible, it may be a few hours before the battery goes dead.
- Hearing aid performance will not change while LOBAT is sounding.

Choosing the Correct Ear Tip

Ear Tips



Triple Flange



Triple Flange
with Stem



Foam

No two ears are exactly alike. The ear tip that is most comfortable is the best choice, but it must seal well to prevent feedback (whistling).

Replacing the Ear Tips

You may change the tip for a more comfortable fit.

REMOVAL: To remove the ear tips, gently pull the tips off of the stem of the device.

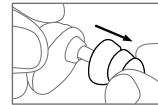

REPLACE: To replace the ear tips, gently push the new tip onto the stem of the device.

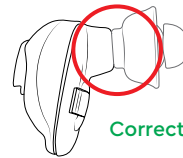
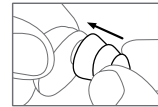

Correct

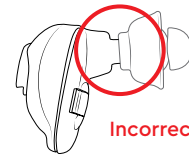

Incorrect

When changing the ear tips, make sure the ear tip fits securely on the stem of the device.



Note: Improper replacement of ear tips could result in the ear tip coming off of the hearing aid and being lodged in the ear canal.

Wearing Your Hearing Aids

INSERTION

- Make sure the ear tip is clean.
- Pull the ear up and out while inserting.
- Twist and push gently until the ear tip seals in the ear canal.
- When using 3-flange ear tips, moistening may ease insertion.
- When using foam ear tips, roll down or compress the foam ear tip before inserting. Hold the ear tip in place for about 5 seconds while foam expands to create a tight seal in the ear canal.

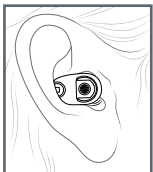

REMOVAL

- Remove hearing aids with a slow twisting motion.
- After removal, place your hearing aids in a protective case.



Importance of a Good Seal

Note: Hearing aids come with a large selection of ear tips, including two sizes of 3-flange ear tips with long stems. Depending on your ear geometry, the longer stems may allow the best seal.

A good ear tip seal ensures the best performance and prevents the "hollow voice" sound, called the occlusion effect.

- The occlusion effect is caused by sound transmission into the ear from vibration of the ear canal wall when the ear is occluded by an ear tip.
- The vibration comes from sound pressure developed in the back of the mouth.
- The occlusion effect is most commonly caused by vibration from a person's own voice, especially from speaking the sounds "ee" and "uu," or from playing a brass or woodwind musical instrument.
- The occlusion effect is worse when there is a shallow insertion of the ear tip.

Operation

ON/OFF

The hearing aids turn on and off by opening and closing the battery door.

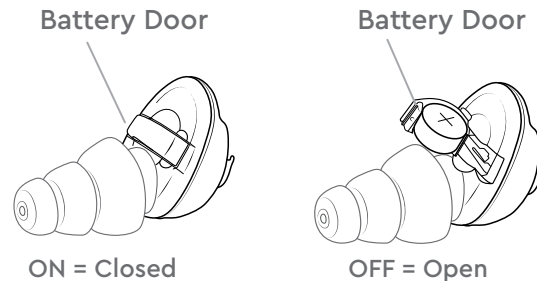

Note: It is not necessary to remove the battery as long as the door is open wide enough to disable the circuit.

Listening Profile Adjustments

There are two listening profiles, Low (L) and High (H).

L: LOW

(switch toward the body of the device)

- 15dB mild amplification and treble boost for soft sounds.
- No amplification for loud sounds.



Low Position

H: HIGH

(switch away from the body of the device)

- 8dB more amplification than the N position, and treble boost for soft sounds.
- Mild amplification for loud sounds.



High Position

Using the Telephone

It is not necessary to remove the hearing aids when using the telephone. If you are comfortable holding the phone on or near the ear and a whistling sound does not occur, the hearing aids can remain in the ear during a call.

General Product Care

Simple cleaning with the tool provided will keep the ear tip clean and the hearing aids working properly.



- Use the cleaning tool to pick out or brush off debris.
- 3-flange ear tips can be removed and cleaned in mild detergent. Dry ear tips thoroughly before reattaching.
- All ear tips need to be replaced regularly. With regular use of hearing aids, 3-flange ear tips should be replaced every 60–90 days.
- Foam and glider ear tips should be discarded and replaced as needed.
- Do not use alcohol to clean hearing aids.
- Remove hearing aids before using hair products.
- Do not expose hearing aids to extreme heat or moisture.
- Avoid dropping or hitting hearing aids on a hard surface.



Important: Keep your hearing aids as clean as possible to maintain maximum performance.

Changing Filters

Each hearing aid has a special filter that enhances sound quality and prevents earwax from entering the device. A filter should be changed if the volume decreases or sound quality declines.

Filter Removal

Note: Use the tool to remove the filter.

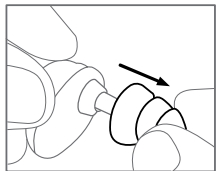

1. Remove ear tip

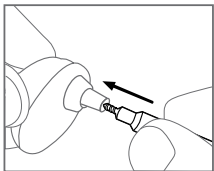

2. Insert tool into the filter

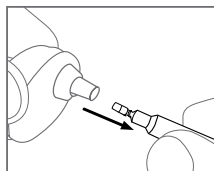

3. Remove filter



Warning: Improper replacement could result in the filter coming out and being lodged in the ear canal.

Filter Replacement

Note: Do NOT use the tool to replace the filter.

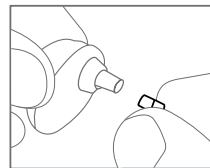

1. Insert new filter

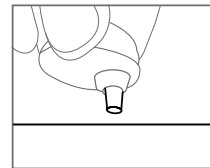

2. Press gently against a hard surface to secure it in place

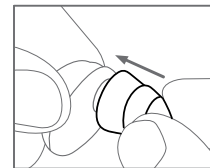

3. Re-attach ear tip

Troubleshooting

ISSUE	POSSIBLE CAUSE	SOLUTIONS
"Dead" or No Sound	Hearing Aid is not turned on	Check to see if the battery door is closed
	Dead battery	Replace battery
	Hearing aids are dirty	Clean the eartip and the end of the hearing aid
	Filter is clogged	Replace the filter
Sound is not loud enough	Amplification is too low	Try the H (high) setting for more amplification
	Hearing aids are dirty	Clean the eartip and the end of the hearing aid
	Filter is clogged	Replace the filter
Voice sounds hollow or there is an echo	You may be experiencing the <i>occlusion effect</i>	Make sure the eartip seals deeply in the ear or try an eartip with a long stem

Still have issues? Reach out to us at **866-202-2527** or chat with us at **lucidhearing.com** and our specialists will be happy to help you.

Your satisfaction is our number one priority!

Technical Data

ANSI TEST

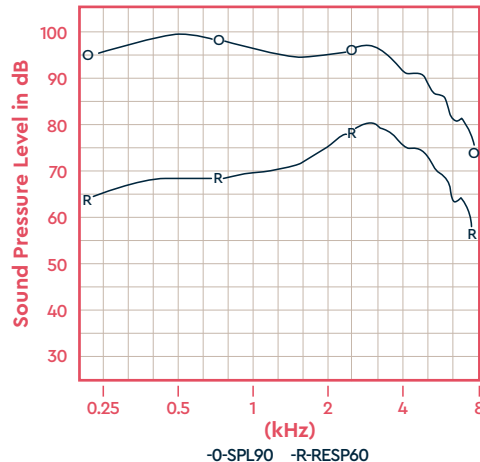

Linear FOG@50 dB
 OSPL90 Max 99.7 dB
 @ 500 Hz
 HFA 95.9 dB
 HFA FOG @ 50 3.6 dB
 RTG TARGET 18.9 dB
 MEASURED 5.4 dB
 EQ Insp noise 33.4 dB
 Resp limit 53.4 dB
 F1< 200 Hz F2>8000 Hz

HFA 1000, 1600, 2500 Hz
 Freq THDist Src
 500Hz 0.5% 70 dB
 800Hz 0.6% 70 dB
 1600Hz 0.2% 65 dB

Battery 1 KHz @ 65 dB
 Zn-Air Unspec 0.00 mA

Warranty

Lucid Hearing OTC products are risk free with a 60 day return period and a 1 year manufacturer's warranty. To file a claim please call us at 866-458-8947.



Warranty Warning: Please do not attempt to make repairs yourself. Doing so could cause additional damage and will void any warranties.

- **Remove** batteries when hearing aids will not be in use for prolonged periods of time.
- **Do not throw** or drop your instruments.
- **Do not immerse** hearing instruments in liquid or water.
- **Do not wear** during bathing, showering, or swimming.
- **Store out of the reach of children and pets.**

- **Do not expose** instruments to excessive heat, such as a stove top, microwave, dashboard of a hot car, or hair dryer.
- **Do not expose** the instruments to chemicals such as hair spray, insect repellent, perfume, or cosmetics.
- **Do not** use the product with higher volume for a long period of time, in order to avoid hearing damage. Stop using if discomfort occurs.
- **Do not disassemble** the device.
- **Avoid use in potential explosive** or dangerous situations.
- **To avoid possible electromagnetic radiation**, the devices should be removed in any high frequency, heat treatment or operation, radiotherapy and strong magnetic field environments.

Battery Safety



CAUTION – Battery Safety Information Hearing Aid Batteries are Dangerous if Swallowed

Keep hearing aids out of the reach of children or anyone who may accidentally swallow them. Never put hearing aids in your mouth for any reason. Do not store in pill containers where they may be mistaken for medication and swallowed. Do not attempt to remove batteries from your device, see your hearing care professional. Do not use any other rechargeable battery; Batteries of low quality may leak and cause bodily harm. Batteries with incorrect voltage may cause damage to your device. They may explode and cause serious injury. Do not expose your hearing aid to heat, such as an open flame, microwave, or oven. There is a risk that they will explode and cause serious injury.

Visit <http://www.poison.org/prevent/battery.asp> to learn more important information about battery safety.

If a battery or hearing instrument is swallowed, see a doctor immediately and call the National Capital Poison Center, 202-625-3333.



Disposal of Instruments
Waste from electronic equipment must be handled according to local regulations.



WARNING: Risk of Fire and Burns. Do not Open, Crush, Heat above 60°C/131°F or incinerate. Do not short circuit. If bulges severely, discontinue use.



Manufactured by:
Etymotic Research, Inc
61 Martin Lane
Elk Grove, IL 60007 USA

Distributed by:
Lucid Hearing Holding Company, LLC
PO BOX 535596
Grand Prairie, TX 75053

Transport & Storage

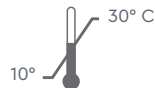

Operational Conditions



Type B applied part



Read Instructions



lucidhearing.com

©2022 Lucid Hearing Holding Company, LLC. Lucid Hearing, Enlite are registered trademarks of Lucid Hearing Holding Company, LLC. All rights reserved.