



THE GROVE AT CANOPY

A STARLING OPERATED COMMUNITY



Welcome to The Grove at Canopy. Welcome Home.

“The greatest adventure
is what lies ahead.”



Welcome to The Grove at Canopy. Welcome Home.

We invite you to explore a new beginning of unmatched convenience and elegance in a carefree oasis of luxury featuring exquisite dining options, resort-style amenities, dynamic engagement opportunities, robust wellness offerings, and personalized services individually catered by an expertly trained staff in a safe and secure environment enabling you to live the life you deserve.

Our Mission

At The Grove at Canopy, our highest mission is to provide the finest professional service in an exceptional environment to ensure our residents experience an extraordinary lifestyle full of unmatched convenience and vitality.





Fulfilling your needs. Enlivening new desires.

A host of robust services and luxurious amenities await at The Grove at Canopy, including:

- Spacious apartments featuring high-end finishes, stainless steel appliances, stone countertops, decorative cabinets, washer/dryers, walk-in closets, and tile showers¹
- Restaurant-style dining at multiple venues, including an elegant main dining room with display kitchen, casual bistro and bar, private dining room, and patio dining
- Unmatched wellness offerings, including a full-service spa and salon, state-of-the-art fitness center, massage room, group exercise classes, therapy studio, and walking trails
- Dynamic engagement opportunities with a full calendar of socials, trips, and events coordinated by a dedicated team of engagement professionals
- Arts and crafts studio, library, game room, multiple lounges, piano parlor, and a multipurpose room for movies, seminars, and events
- On-site team of nurses and caregivers 24/7 and convenient access to wellness professionals offering home health and therapy services
- Multiple outdoor amenities, including a fire pit, resident gardening area, water features, walking trails, croquet lawn, dog park, chicken coop, and multiple generously landscaped courtyards
- Complimentary scheduled transportation, housekeeping, trash removal, and linen services
- Best in-class technology featuring full WiFi coverage across the community, state-of-the-art nurse call system, digital signage, dedicated touchscreen TV for engagement and brain fitness, electronic health records, and medication management systems

¹ Certain features not available in Memory Care apartments



First-class, personalized service

At The Grove at Canopy, you will experience personalized service from an attentive and professional staff, including:

- Full-service culinary team led by an executive gourmet chef offering tableside service at multiple restaurant-style dining venues
- Housekeeping, trash removal, and linen services provided by a dedicated team of housekeepers
- Professional environmental services team to assist with all your maintenance needs
- Uplifting engagement team implementing a full and dynamic calendar of socials, activities, trips, and educational offerings
- Complimentary scheduled transportation
- Robust wellness offerings provided 24/7 by our on-site team of dedicated nurses and caregivers as well as our premier partners, including instructor-led fitness classes, on-site therapy, third-party home health services, a professionally managed spa and salon, and visiting healthcare providers
- 24/7 security
- On-site concierge to assist with personal requests

Culinary delights

No matter your craving, from a light snack to a fine dining experience, The Grove at Canopy offers a wide range of exquisite dining options. Our on-site gourmet chefs are constantly adapting, perfecting, and creating dishes that delight the taste buds and ignite the senses. With multiple dining venues including our elegant main dining room with a display kitchen, casual bistro and bar, patio dining, and an intimate private dining room, residents decide where and what they would like to eat from our meticulously crafted menus.







Dynamic engagement

The Grove at Canopy provides ample opportunities for residents to pursue new interests and enjoy existing hobbies. Whether you are participating in an educational seminar, hitting the game winner on the croquet lawn, enjoying a glass of wine among friends, or visiting a local cultural destination, The Grove at Canopy makes it easy to engage the imagination and enjoy life. In addition to a dynamic social calendar curated by a dedicated team of engagement professionals, a wide spectrum of premier on-site amenities ensure a new adventure is always at your fingertips.

Outdoors:

- Multiple lush courtyards
- Expansive resident gardening area
- Outdoor fire pit and water features
- Walking trails
- Chicken coop
- Butterfly gardens
- Croquet lawn
- Dog park

Indoors:

- Expansive multipurpose room for movies, seminars, religious services, and social events
- Indoor fireplace and piano lounge
- Activities studio for arts, crafts, classes, and games
- Library and business center
- Multiple well-appointed lounges and living areas for reading, playing cards and games, watching TV, and relaxing
- Full-service bar

Robust wellness

The Grove at Canopy features expansive wellness offerings, including:

- **Spa & Salon:** full-service, professionally-managed spa and salon featuring a nail bar and massage room
- **Fitness:** state-of-the-art fitness center and instructor-led group exercise classes
- **Therapy:** full-service, professionally-managed therapy studio offering physical, speech, and occupational therapy services
- **Wellness Partners:** convenient access to third-party home health, therapy, and physician partners providing a range of wellness offerings
- **Care:** Dedicated on-site team of nurses and professionally-trained caregivers staffed 24/7







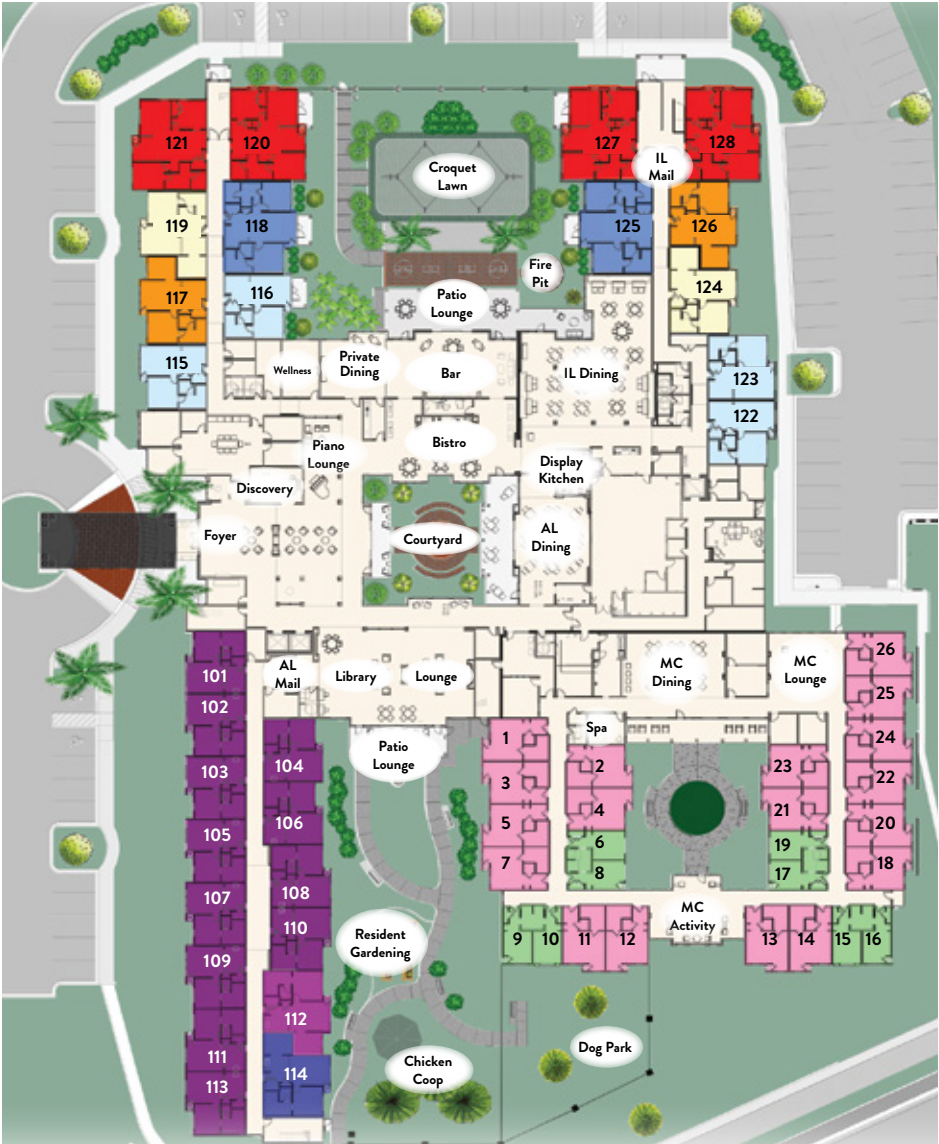

1ST FLOOR

Independent Living

Longleaf (669 sf)	1 Bedroom
Cypress (753 sf)	1 Bedroom + Den
Dogwood (753 sf)	1 Bedroom + Den
Palmetto (999 sf)	2 Bedroom
Live Oak (1,051 sf)	2 Bedroom

Assisted Living

Sycamore (570 sf)	1 Bedroom
Elm (753 sf)	1 Bedroom + Den
Cedar (753 sf)	1 Bedroom + Den

Memory Care

Maple (431 sf)	Studio
Magnolia (290 sf)	Companion Suite

2ND FLOOR

Independent Living

Longleaf (669 sf)	1 Bedroom
Cypress (753 sf)	1 Bedroom + Den
Dogwood (753 sf)	1 Bedroom + Den
Palmetto (999 sf)	2 Bedroom
Live Oak (1,051 sf)	2 Bedroom

Assisted Living

Sycamore (570 sf)	1 Bedroom
Elm (753 sf)	1 Bedroom + Den
Cedar (753 sf)	1 Bedroom + Den

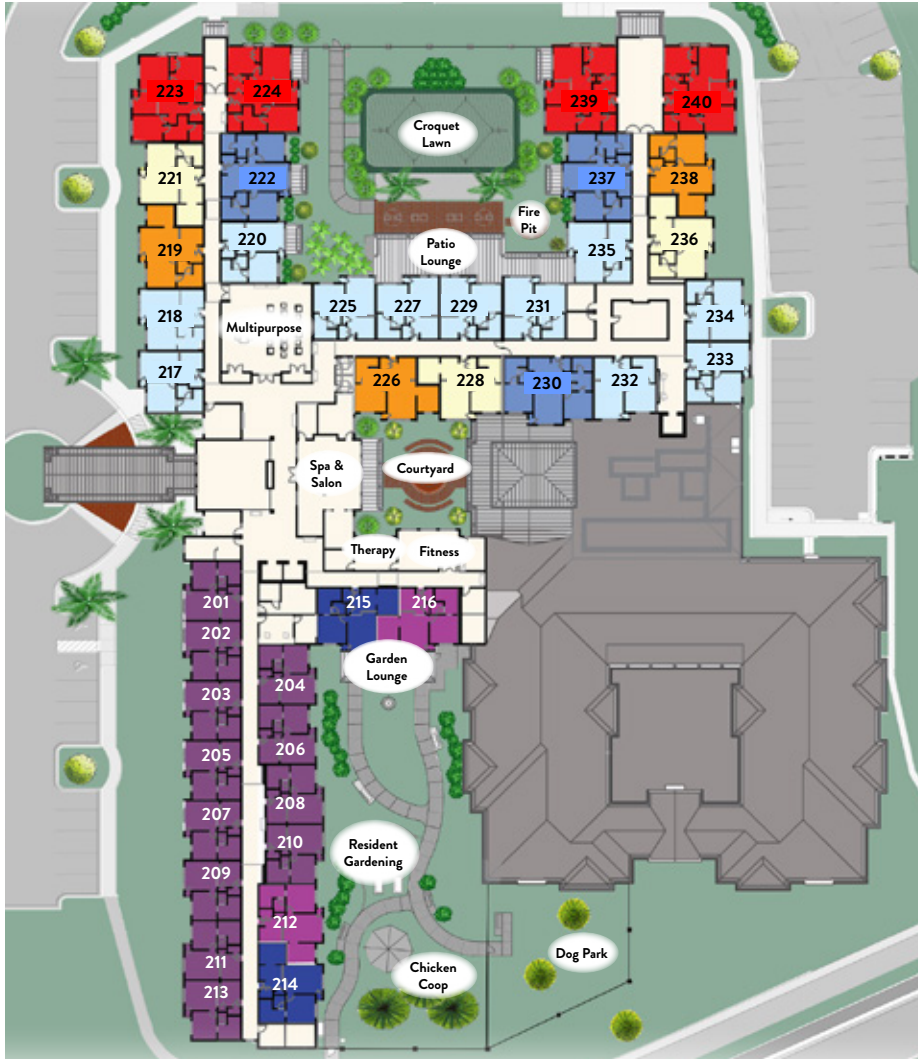

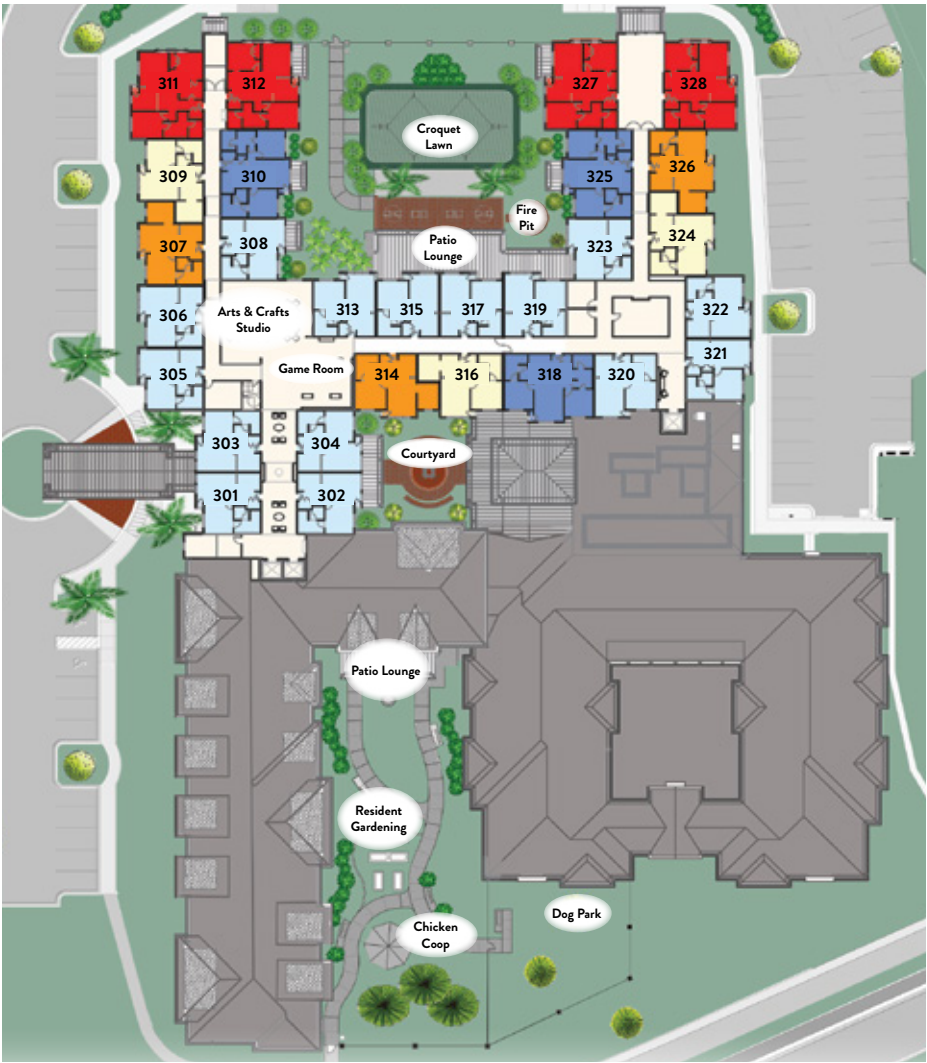

3RD FLOOR

Independent Living

Longleaf (669 sf)	1 Bedroom
Cypress (753 sf)	1 Bedroom + Den
Dogwood (753 sf)	1 Bedroom + Den
Palmetto (999 sf)	2 Bedroom
Live Oak (1,051 sf)	2 Bedroom

Assisted Living

Sycamore (570 sf)	1 Bedroom
Elm (753 sf)	1 Bedroom + Den
Cedar (753 sf)	1 Bedroom + Den

Independent Living

Amenities and Features

Independent Living is ideal for individuals looking to enjoy a hospitality-rich lifestyle full of convenience and luxury in a dynamic social community. Access an array of amenities and programs tailored to suit your desires, while living in your maintenance-free, spacious apartment. Dynamic engagement opportunities, personalized services, and gourmet dining make The Grove at Canopy the perfect place to pursue your passions and engage in a vibrant lifestyle.

Amenities and Services:

- Multiple full-service, restaurant-style dining venues
- Weekly housekeeping, trash removal and linen services
- Full-time environmental services staff to assist with your maintenance needs
- Dedicated team of engagement professionals implementing a dynamic calendar of socials, activities, trips and educational offerings
- Complimentary scheduled transportation
- Robust wellness offerings including a spa, salon, nail bar, massage room, and instructor-led exercise classes
- 24/7 security
- Concierge for personal requests
- Access to home health, therapy, and visiting medical professionals
- Peace of mind knowing personalized care services are provided on site should additional needs arise

Apartment Features:

- Expansive One-Bedroom, One-Bedroom + Den, and Two Bedroom floor plans
- Kitchens with high-end cabinets, full-size, stainless steel appliances, and stone countertops
- Large bathrooms with walk-in tile showers and upscale finishes
- Large walk-in closets
- Washer and dryers in all apartments
- Emergency call system, WiFi Internet service, and individually controlled heating and air conditioning

Independent Living Floor Plans



Longleaf (669 sq ft) – 1 Bedroom, 1 Bath



Cypress or Dogwood (753 sq ft) – 1 Bedroom + Den, 1 Bath*



Palmetto (999 sq ft) – 2 Bedroom, 2 Bath



Live Oak (1051 sq ft) – 2 Bedroom, 2 Bath

Floor plans are artist's renderings. All dimensions are approximate. Actual products and specifications may vary in dimension and detail.
Furniture not included and not all features are available in every apartment.

*Cypress floor plan features Den on window side, and Dogwood floor plan features Den on hallway side.

Assisted Living

Amenities and Features

The Grove at Canopy's Assisted Living lifestyle is designed to nurture your mind and body through robust wellness programs, first-class dining experiences, dynamic engagement offerings, and compassionate care from our dedicated team of professionally-trained nurses and caregivers. Our transparent and predictable care plans are uniquely offered on an a la carte or all-inclusive basis to ensure our personalized services are tailored to your individual needs.

Amenities and Services:

- Multiple full-service, restaurant-style dining venues
- Daily trash removal and weekly housekeeping and linen services
- Full-time environmental services staff to assist with your maintenance needs
- Dedicated team of engagement professionals implementing a full and dynamic calendar of socials, activities, trips and educational offerings
- Complimentary scheduled transportation
- Robust wellness offerings including a spa, salon, nail bar, massage room, and instructor-led exercise classes
- 24/7 security
- 24/7 care provided by professionally-trained caregivers and licensed nurses
- Concierge for personal requests
- Access to home health, therapy, and visiting medical professionals
- Electronic health records and medication management systems

Apartment Features:

- Expansive One-Bedroom and One-Bedroom plus Den floor plans
- Kitchens with high-end cabinets, full-size, stainless steel appliances, and stone countertops
- Large bathrooms with walk-in tile showers and upscale finishes
- Large walk-in closets
- Washer and dryers in all apartments
- Emergency call system, WiFi Internet service, and individually controlled heating and air conditioning

Assisted Living Floor Plans



Sycamore (570 sq ft) – 1 Bedroom, 1 Bath



Elm (753 sq ft) – 1 Bedroom, 1 Bath + Den



Cedar (753 sq ft) – 1 Bedroom, 1 Bath + Den

Floor plans are artist's renderings. All dimensions are approximate. Actual products and specifications may vary in dimension and detail.
Furniture not included and not all features are available in every apartment.

Memory Care

Amenities and Features

The loss of memory and cognition doesn't have to mean a loss of dignity and independence. Our all-inclusive Memory Care program is purposefully designed to provide a stimulating atmosphere that encourages engagement and well-being in a comfortable and secure environment. Residents benefit from personalized programming, full service dining experiences, and specialized wellness and engagement activities, while enjoying the comfort and security of a residence they're proud to call home.

Amenities and Services:

- Dedicated Memory Care Director
- Individual care plans for each resident
- Specialized and personalized dining program
- Daily trash removal and weekly housekeeping and linen services
- Full-time environmental services staff to assist with your maintenance needs
- Resident-centered guidance and programming integrating daily living activities and promoting engagement
- Dedicated spa and salon
- 24/7 security
- 24/7 care provided by professionally-trained caregivers and licensed nurses
- Electronic health records and medication management systems
- Medication supervision provided by a licensed nurse

Apartment Features:

- Spacious Studio and Companion Suite floor plans
- Vinyl wood flooring
- Large bathrooms with walk-in tile showers and upscale finishes
- Individually controlled heating and air conditioning

Memory Care Floor Plans



Maple (431 sq ft) – Studio



Magnolia (290 sq ft) – Companion Suite

Floor plans are artist's renderings. All dimensions are approximate. Actual products and specifications may vary in dimension and detail.
Furniture not included and not all features are available in every apartment. Companion Suite area includes shared bathroom.

Neighborhood overview

The Grove at Canopy is situated in Canopy, a premier master-planned community along the Miccosukee Greenway offering residents access to nearly 10 miles of nature trails and multi-use paths, numerous parks and lakes, and community-wide events such as food truck nights, movies in the park, live music, and more.

Nearby establishments and services include a Publix-anchored shopping center, multiple country clubs, premier hospitals including Capital Regional and Tallahassee Memorial, numerous places of worship, movie theaters, and cultural destinations such as Goodwood Museum & Gardens and AMC Tallahassee.





LEGEND

Arts, Culture, and Entertainment

Hospitals

Colleges and Universities

Places of Worship

Shopping



Getting started

If you would like to learn more about The Grove at Canopy, please contact us anytime to schedule a visit or receive more information.

PHONE: 850.219.2196

ADDRESS: 2601 Crestline Rd, Tallahassee, FL 32308

WEB: GroveAtCanopy.com

EMAIL: Canopy@StarlingLiving.com

Assisted Living License Pending



THE GROVE AT CANOPY

A STARLING OPERATED COMMUNITY

Independent Living | Assisted Living | Memory Care